



Vogt AG Verbindungstechnik

www.vogt.ch



creating connections



COMPANY PROFILE

Swiss quality at fair prices

- Founded in 1962
- Around 120 employees
- 4 production facilities in Switzerland
- 2 billion parts per year
- Worldwide network of representatives
- Focus on core competency and niche markets

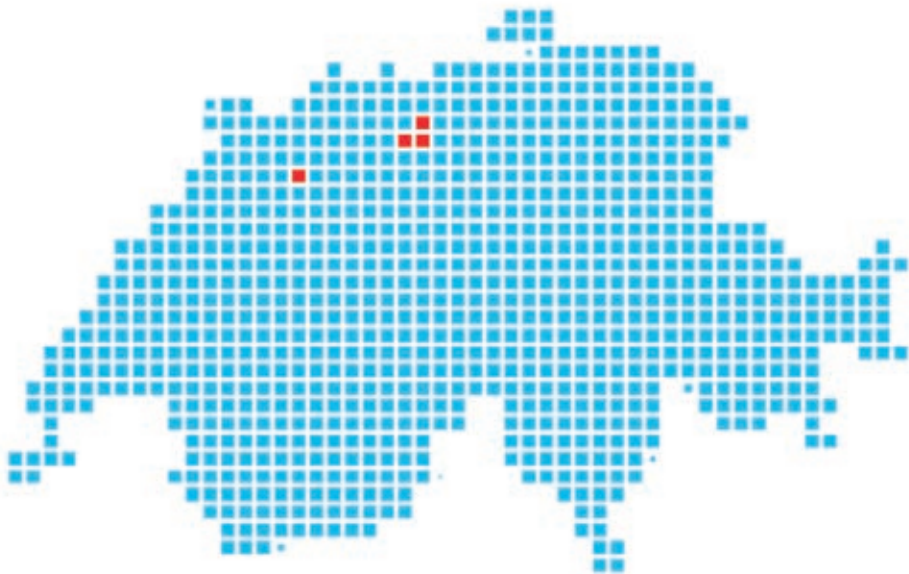

The best from ...

STAMPING



+ 3,800 items

PIPE



+ 2,500 items

... four product categories

WIRE



+ 250 items

PLASTIC



+ 500 items





SPECIAL PRODUCTS

Tailored to your wishes ...

We respond to increased customer demands with specific products from our own production that are precisely tailored to your needs.





STANDARD PRODUCTS

... or from the standard product range

You are guaranteed to find the product you are looking for among our product range of more than 13,000 items for electromechanical press-fit technology.





STAMPING



- Standalone stamping factory
- From the idea to the finished product
- Experienced, in-house toolmaking
- State-of-the-art CAD tools



STAMPING



From your initial idea to the finished product, and with no limits to complexity and amount, we produce premium-quality precision items on 20 Swiss stamping machines with state-of-the-art control units.





STAMPING

Dimensions of stamped parts	
Area	max. 80 × 50 mm
Bandwidth	6 to 90 mm
Size of slits/holes	min. 1.2 × material thickness

Material thickness	
Individual parts	min. 0.2 mm / max. 2.0 mm
Rolled products	min. 0.1 mm

Tool types
Channel cuts, complete cuts, progressive tools and tools with an integrated thread-shaping unit.





PIPE



- Fully-automatic pipe processing
- Coil or bar material and profiles
- Fine pipe processing: Sawing, reshaping, chamfering, widening, slitting and deforming
- Alternatives to turned parts



PIPE

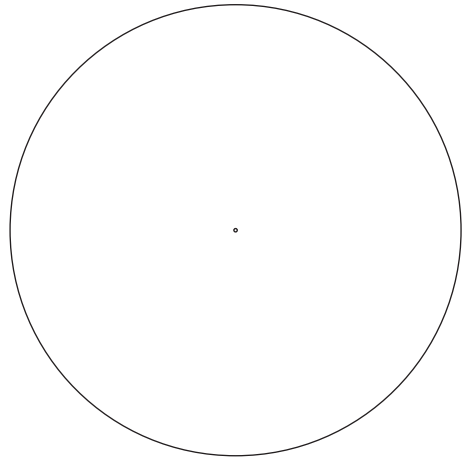

Smallest/largest \varnothing 1:1

Our pipe processing includes sawing, reshaping (crimping), chamfering, widening, slitting, or deforming. Thanks to the high precision, we are able to manufacture alternatives to turned parts. These processes produce products such as spacer tubes, crimp sleeves, wire-end ferrules and tubular rivets.



PIPE

Crimp sleeves	
$\varnothing D$	1 mm to 20 mm
s	0.2 mm to 0.9 mm
L	2 mm to 160 mm

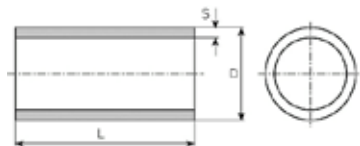

Always includes the right processing tools, from a simple hand tool to the processing machine.







318
7907

437325 (6530)

M1002

318-3704

PIPE

Standard pipe sections	
$\varnothing D$	0.8 mm to 33.0 mm
s	0.15 mm to 5.0 mm
L	Coil tube 2.0 mm to 44.0 mm
L	Rod tube 2.0 mm bis 160 mm

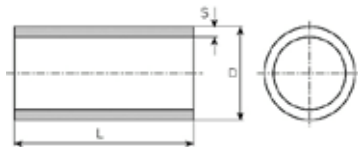

Special tubular part manufacturing available upon request	
$\varnothing D$	10.0 mm to 60.0 mm
s	1.0 mm to full material
L	10.0 mm to 35.0 mm to diameter D max. 20 mm
L	35.0 mm to 350 mm for diameter D 10 mm–60 mm

Processing on both sides such as chamfering, etc. upon request.



PIPE

Tubular rivets according to DIN	
Diameter	min. \varnothing 0.80 mm to max. \varnothing 16 mm
Wall thicknesses	min. 0.15 mm to max. 0.5 mm



Form A



Form B



Form C

Special versions and lengths upon request





WIRE



- Manufacturing of round and square wire pins
- Straight wire parts through to products with compressed collar
- Angled wire parts
- Further processing of components such as headers
- Numerous optional extras

WIRE



We process round or square wire pins in common metals, such as copper and copper alloys, aluminium, reels of steel or stainless steel on our specially designed systems and devices.



PLASTIC



Our production is seeing steady growth in the manufacture of plastic parts. Extrusion-coated tube and stamped parts play an increasingly important role. A large part of our product portfolio is also made up of pure plastic parts.





PLASTIC

Overmoulding of metal parts	
Material	all metallic materials
Further processing	on rotary tables, push-in cartridge tools or fully automated systems

Material	Polypropylene to polyetherimide
Part weight	0.02 to 200 g
Closing force	25 to 80 tons

Processing methods	drilling, milling, turning, grinding, EDM
Post-operations	module assembly, customised packaging available



PLASTIC



We process thermoplastics and thermoplastic elastomers, such as:

- **Polyamide**
- **Polycarbonate**
- **Polyethylene**
- **Polypropylene**
- **Polystyrene**
- **PVC**
- **PTFE**
- **High Density Polyethylene**

Price/Performance

Temperature

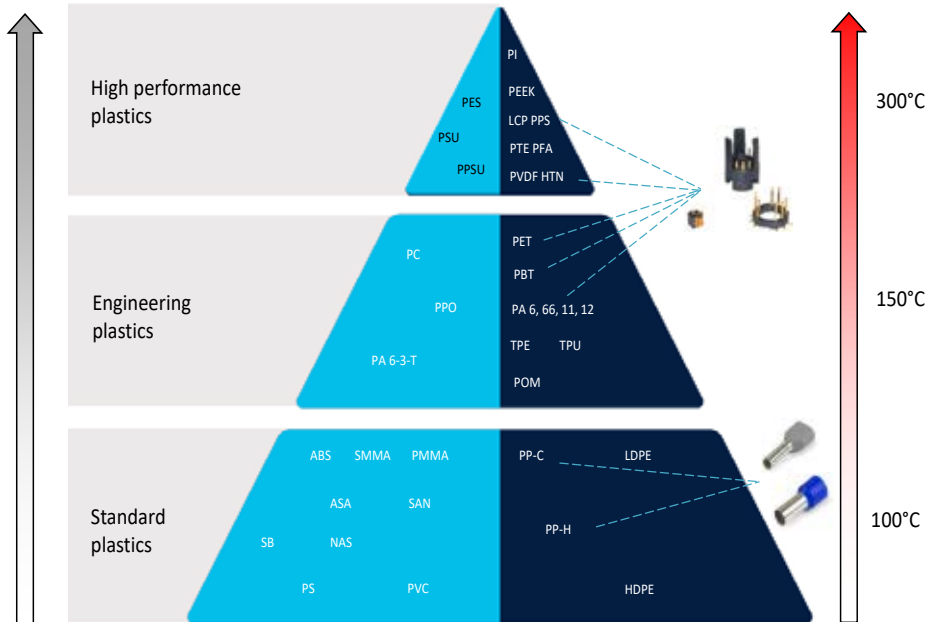

amorphous

semi-crystalline



THT MODULES FOR PCBs

Nominal dimensions
2.8 mm
4.8 mm
6.3 mm
9.5 mm

Tabs / Receptacles for pins

1-pin / 2-pin / multiple
Straight and angled

Special sizes available on request

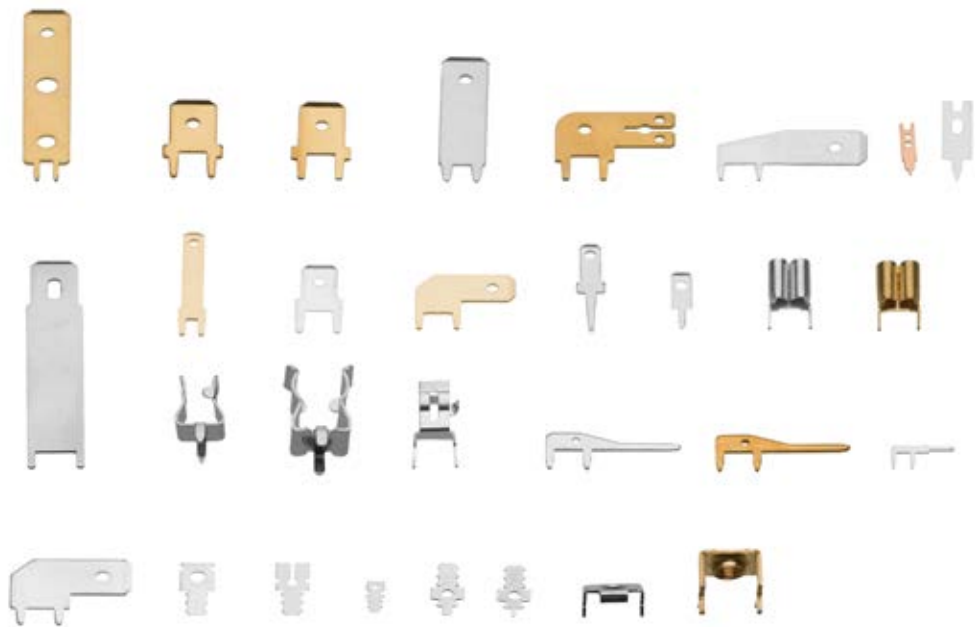



ROUND WIRE PLUG PINS

Round plug pins	
Ø	1 mm / 1.3 mm / 1.32 mm / 1.56 mm
L	max. 20 mm
D	2.5 mm to 6.5 mm

in chain form



straight



embossed



Other Ø and lengths available on request



SQUARE WIRE PLUG PINS

Square plug pins	
∅	0.63 mm / 1.1 mm / 1.14 mm
L	6 mm to 70 mm

Other diameters and lengths available on request



Square plug pins available as rolled products on request



R2

9,65 ±0,1

7,25 ±0,05

16,90 ±0,1

±0,1 (3x)

0,1





CQUL
275V~
X2.L

SMD MODULES FOR PCBs

Blade terminals / Screw fixations / Contact bridges / Clamping spring



Special sizes available on request



BLISTER/AUTOMATED ASSEMBLY

For THT and SMD parts







CABLE TERMINALS / TABS

Nominal dimensions	2.8	4.8	6.3
---------------------------	-----	-----	-----



Other designs on request



CABLE TERMINALS / RECEPTACLES FOR PINS

Nominal dimensions	2.8	4.8	6.3
---------------------------	-----	-----	-----

Cable cross-section 0.14 mm² to 6 mm²

non-insulated



part insulated



fully insulated



Other designs on request



CABLE TERMINALS / RECEPTACLES FOR PINS

Stranding class
per specifications



Strand length
per specifications



Wire-end ferrules



Crimping tool



Cable cross-section 0.25 mm² to 70 mm²

individual
with PP

in strips and chain
from with PP

double with PP

Short and
ground fault-
proof with PA



UL tested

Other designs on request





CABLE TERMINALS / CABLE LUGS AND SPLICES

Solderless terminals



Crimp terminals



Tubular terminals



Cable cross-section 0.25 mm² to 300 mm²

Butt-splices with or without insulation



SOLUTIONS FOR CONNECTION PROJECTS

Can't find the part you want in the standard range of products?

We can make individual products for you and your application.
Our team is happy to advise you!

- **Your contact**
- **No interfaces**
- **Individual and hybrid parts as well as modules**
- **Individual designs**
- **Flexible batch sizes and number of parts**





ADVICE AND ENGINEERING

Our aim is to offer our customers the best possible service with a treasure chest of ideas, right from the word go. Build on our manufacturing know-how.

- **Support in the development and construction of customer solutions**
- **Prototypes and series tools**
- **High level of expertise in the manufacture of individual components to complete modules**



QUALITY CHECKS / MEASURING TECHNOLOGY

The 3D measurement laboratory at Vogt AG in Lostorf specialises in high-precision measurements under laboratory conditions. Our customers save valuable time and get more useful measurement results through our use of the latest software, standard-compliant documentation and efficient service.

- **Proven quality with our in-house measurement laboratory**
- **Initial samples**
- **Complete metrological solutions**
- **Fulfilment of the highest quality standards**





42
Watt

Elektronik-Technik
Werkzeug

0,15 Watt

1,50

mm²

1,00

PACKAGING

In addition to the type of packaging, the labelling can also be selected to suit individual requirements. It is important to be able to automatically identify the product by means of a barcode, not just when it is received, but also when it is taken out of stock. The batch numbers are also linked with the latest DataMatrix codes printed on the labels to ensure traceability.

- **Blister, tape & reel**
- **Bag**
- **Labelling**
- **Product range boxes**
- **Euro bracket**



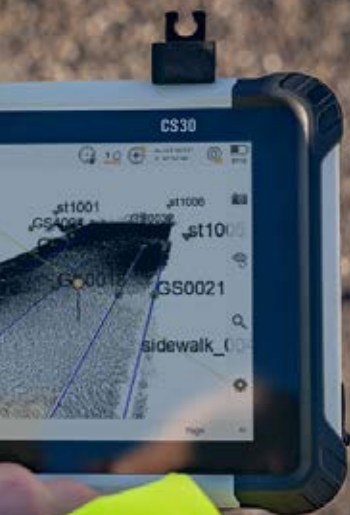

CONTACT SLEEVES FOR TOTAL STATIONS



Vogt contact parts are used for high-precision applications. In the field of terrestrial surveying, total stations are used for the highly accurate determination of horizontal/vertical angles as well as object coordinates for testing prefabricated construction elements or the setting out of design data in construction projects.





MODULE FOR ACOUSTIC TRANSDUCER



HB-THERM is the technology leader in the manufacture of tempering units. For the new Termo-6 series, we were able to work closely with the customer to create a complex assembly and connector housing.



FIXING LEVER FOR SENSORS

Vogt manufactures fastening lever made of PPS plastic for the world's largest telescope, which will be built in the desert in Chile by 2025. The individual parts of the assembly are produced grease and silicone-free, and care is taken to ensure there is no burr formation. When processing the parts further they must be dust-free, and gloves must be worn when handling them. The lever meets Micro-Epsilon's high requirements in terms of sensitivity to external influences as well as high precision (tele-optical without errors during 100% final inspection). The item number and series number are laser printed with a QR code (by ARGO).



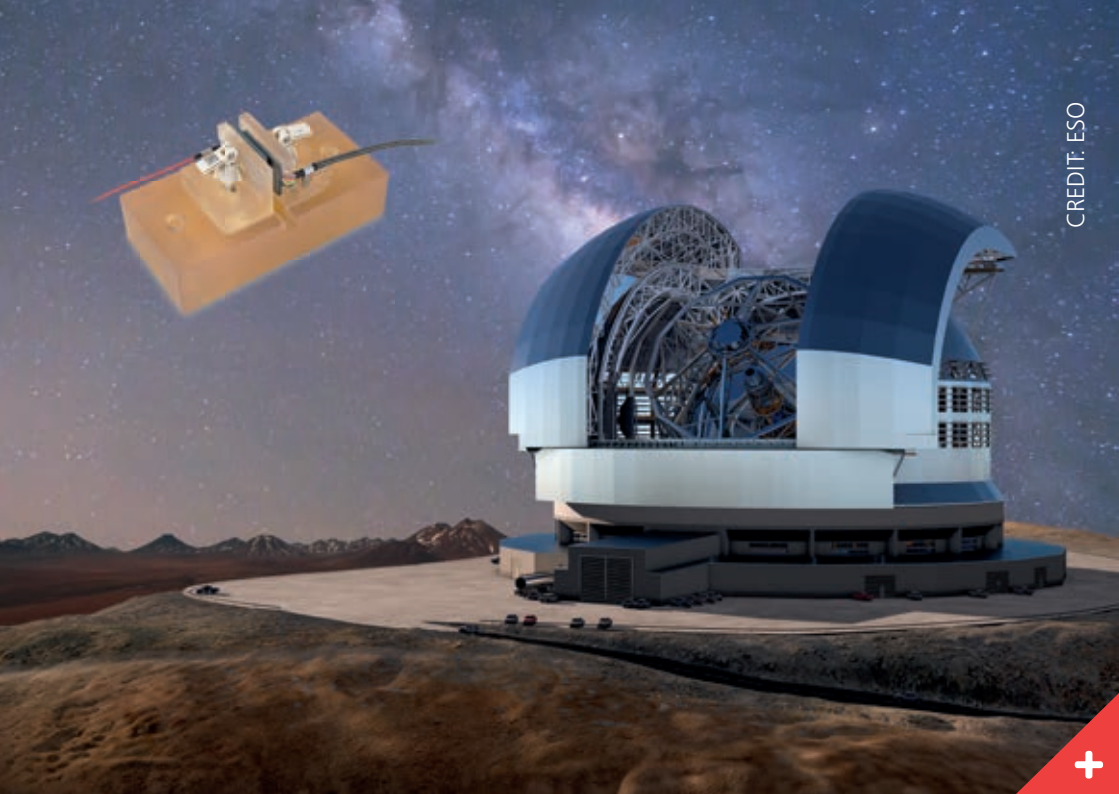

CREDIT: ESO





BATTERY CONTACT FOR WELDING HELMET



Inside each automatic welding helmet is the cartridge that combines both the technology and the know-how. Part of this cartridge is a printed circuit board upon which the controller is integrated that regulates the liquid crystal display depending on the brightness. Vogt AG has produced complex battery contacts for the company based in Eastern Switzerland.



MATERIALS

Aluminium



Beryllium copper



Bronze



Cupronickel



Copper



Spring steel



Brass



Nickel silver



Stainless steel



Steel and stainless steel



Nickel







SURFACES

Blank



Silver-plated



Gold-plated



Bronzed



Pure tin-plated / solderable



Reflow



Nickel-plated



Galvanised



Anodised



Sucopro



Sucoplate



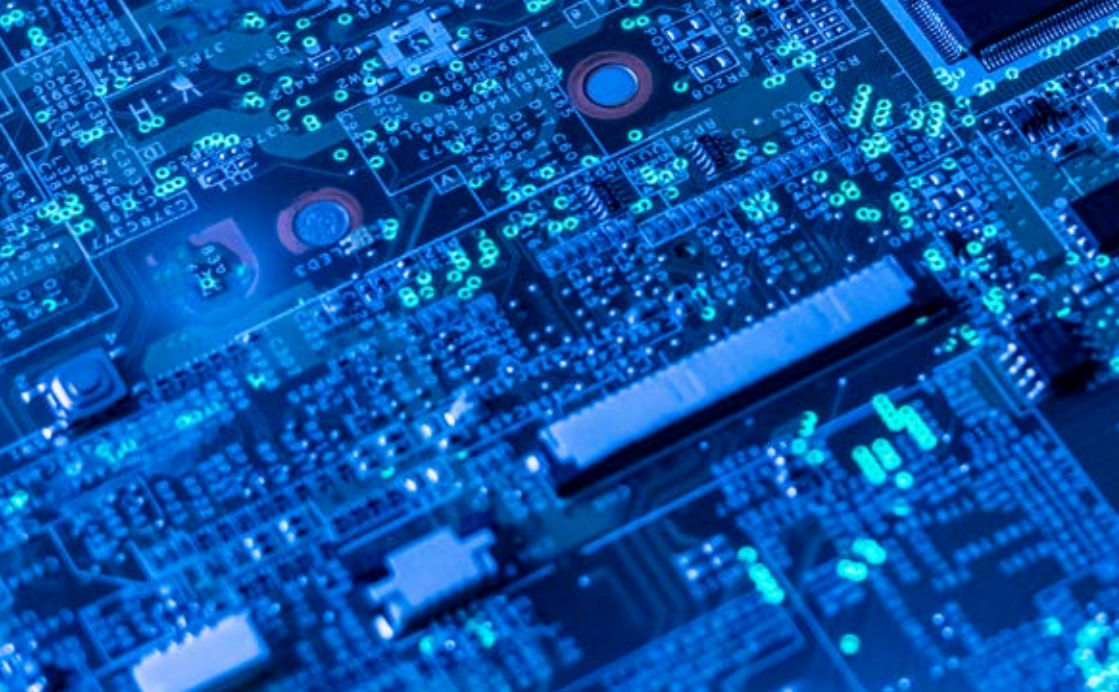

Vogt AG Verbindungstechnik, CH-4654 Lostorf